

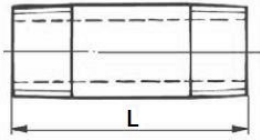

BDE (NORTHAMPTON) LTD

BSP FITTINGS 316 - 150LB PRESSURE RATING



• BSP BARREL NIPPLE 316

SIZE	1/8"	1/4"	3/8"	1/2"	3/4"	1"
L	30.00	30.00	50.00	60.00	60.00	60.00
SIZE	1.25"	1.5"	2"	2.5"	3"	4"
L	75.00	80.00	100.00	100.00	120.00	120.00

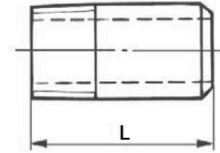

• BSP WELD NIPPLE 316

SIZE	1/8"	1/4"	3/8"	1/2"	3/4"	1"
L	30.00	30.00	30.00	35.00	40.00	40.00
SIZE	1.25"	1.5"	2"	2.5"	3"	4"
L	50.00	50.00	50.00	60.00	70.00	80.00

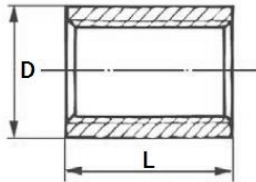

• BSP FULL SOCKET 316

SIZE	1/8"	1/4"	3/8"	1/2"	3/4"	1"
D	14.0	18.5	21.5	26.5	32.0	39.5
L	20.0	25.0	26.0	34.0	36.0	43.0
SIZE	1.25"	1.5"	2"	2.5"	3"	4"
D	48.5	54.5	66.5	82.0	95.0	122.0
L	48.0	48.0	56.0	65.0	70.7	83.0

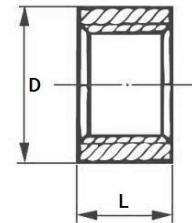

• BSP HALF SOCKET 316

SIZE	1/8"	1/4"	3/8"	1/2"	3/4"	1"
D	14.0	18.5	21.5	26.5	32.0	39.5
L	11.00	13.00	12.00	15.00	17.00	20.00
SIZE	1.25"	1.5"	2"	2.5"	3"	4"
D	48.5	54.5	66.5	82.0	95.0	122.0
L	22.00	22.00	26.00	30.00	33.00	40.00

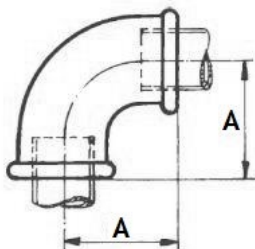

• BSP F/F 90d ELBOW 316

SIZE	1/8"	1/4"	3/8"	1/2"	3/4"	1"
A	14.00	18.50	20.80	25.00	27.50	33.00
SIZE	1.25"	1.5"	2"	2.5"	3"	4"
A	39.50	43.00	52.00	61.00	70.50	89.00

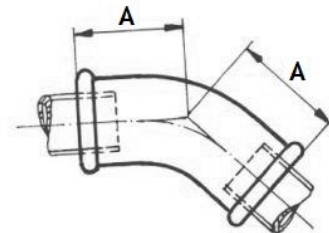

• BSP F/F 45d ELBOW 316

SIZE	1/8"	1/4"	3/8"	1/2"	3/4"	1"
A	17.70	18.60	20.50	22.50	25.00	28.20
SIZE	1.25"	1.5"	2"	2.5"	3"	4"
A	28.20	36.40	43.00	47.00	52.00	63.00

DIMENSIONS ARE A GUIDE
ONLY AND MAY VARY



BDE (NORTHAMPTON) LTD

BSP FITTINGS 316 - 150LB PRESSURE RATING

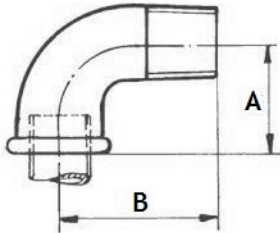

• **BSP M/F 90^d STREET ELBOW 316**

SIZE	1/8"	1/4"	3/8"	1/2"	3/4"	1"
A	15.40	17.60	20.50	20.50	24.00	30.00
B	23.00	27.00	30.00	30.00	34.50	39.50
SIZE	1.25"	1.5"	2"	2.5"	3"	4"
A	35.50	38.50	48.00	62.50	79.30	100.50
B	46.50	49.50	60.50	87.00	106.50	126.30

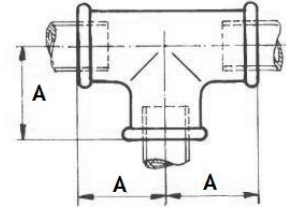

• **BSP F/F/F EQUAL TEE 316**

SIZE	1/8"	1/4"	3/8"	1/2"	3/4"	1"
A	14.00	18.50	20.80	25.00	27.50	33.00
SIZE	1.25"	1.5"	2"	2.5"	3"	4"
A	40.00	43.00	52.00	61.00	70.50	89.00

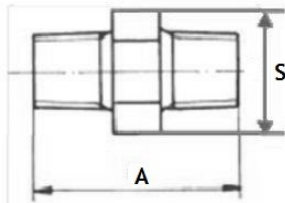

• **BSP HEX NIPPLE 316**

SIZE	1/8"	1/4"	3/8"	1/2"	3/4"	1"
A	29.50	28.00	31.00	33.50	38.00	41.50
S	10.00	14.60	18.10	22.40	28.00	35.00
SIZE	1.25"	1.5"	2"	2.5"	3"	4"
A	48.50	48.50	57.00	67.00	75.00	81.00
S	44.00	50.00	62.00	78.00	91.00	116.00

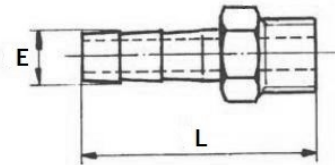

• **BSP HOSE NIPPLE 316**

SIZE	1/8"	1/4"	3/8"	1/2"	3/4"	1"
L	29.00	40.00	40.00	47.50	50.50	61.00
E	7.00	9.00	11.00	13.00	20.00	25.00
SIZE	1.25"	1.5"	2"	2.5"	3"	4"
L	63.50	75.00	79.00	89.00	102.50	109.00
E	33.00	39.00	51.00	65.00	77.50	103.00

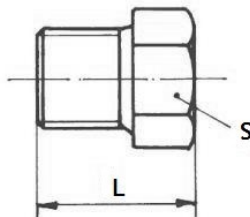

• **BSP HEX PLUG 316**

SIZE	1/8"	1/4"	3/8"	1/2"	3/4"	1"
L	17.70	17.70	18.50	19.50	22.00	24.80
S	16.80	16.80	18.00	22.00	28.00	35.00
SIZE	1.25"	1.5"	2"	2.5"	3"	4"
L	28.80	28.80	33.50	34.00	37.50	44.00
S	44.00	50.00	62.00	78.00	91.00	116.00

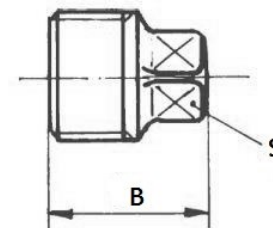

• **BSP SQUARE PLUG 316**

SIZE	1/8"	1/4"	3/8"	1/2"	3/4"	1"
B	15.50	19.00	18.00	18.50	21.00	24.00
S	7.00	8.00	9.00	10.00	14.00	17.00
SIZE	1.25"	1.5"	2"	2.5"	3"	4"
B	28.00	28.00	34.00	38.50	41.50	51.50
S	20.00	23.00	28.00	36.00	40.00	52.00



BDE (NORTHAMPTON) LTD

BSP FITTINGS 316 - 150LB PRESSURE RATING

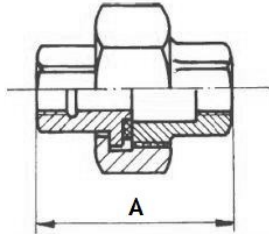

• **BSP F/F UNION 316**

SIZE	1/8"	1/4"	3/8"	1/2"	3/4"	1"
A	35.00	35.00	35.10	38.10	40.50	49.30
SIZE	1.25"	1.5"	2"	2.5"	3"	4"
A	50.50	57.60	63.40	66.50	75.50	89.10

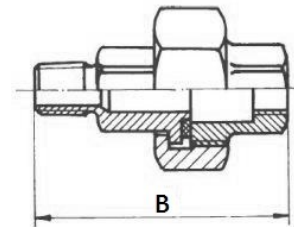

• **BSP M/F UNION 316**

SIZE	1/8"	1/4"	3/8"	1/2"	3/4"	1"
B	-	-	-	52.30	59.60	70.00
SIZE	1.25"	1.5"	2"	2.5"	3"	4"
B	75.80	80.70	87.50	-	-	-

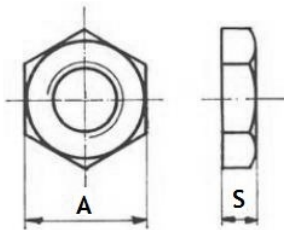

• **BSP LOCKNUT 316**

SIZE	1/8"	1/4"	3/8"	1/2"	3/4"	1"
A	/	6	7	8	9	10
S	/	22.00	27.00	32.00	36.00	46.00
SIZE	1.25"	1.5"	2"	2.5"	3"	4"
A	11	12	13	/	/	/
S	55.00	60.00	75.00	/	/	/

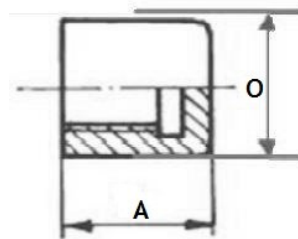

• **BSP ROUND CAP 316**

SIZE	1/8"	1/4"	3/8"	1/2"	3/4"	1"
A	11.5	13.4	16.9	18.6	20.0	23.0
O	16.5	19.8	21.4	25.6	31.8	39.0
SIZE	1.25"	1.5"	2"	2.5"	3"	4"
A	26.2	26.2	31.0	31.7	35.1	41.6
O	48.4	54.4	67.0	84.0	98.0	124.0

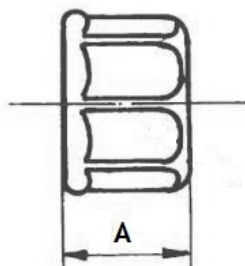

• **BSP HEX CAP 316**

SIZE	1/8"	1/4"	3/8"	1/2"	3/4"	1"
A	11.8	15	15.4	17.1	18.5	21
SIZE	1.25"	1.5"	2"	2.5"	3"	4"
A	23.7	23.7	27.5	31.7	35.1	41.6

**DIMENSIONS ARE A GUIDE
ONLY AND MAY VARY**



BDE (NORTHAMPTON) LTD

BSP FITTINGS 316 - 150LB PRESSURE RATING

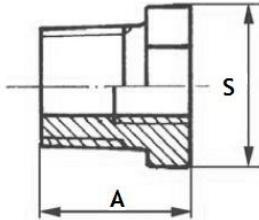

• **BSP REDUCING BUSH 316**

SIZE	A	S
1/4" x 1/8"	14.5	18.0
3/8" x 1/8"	16.0	21.4
3/8" x 1/4"	16.0	27.0
1/2" x 1/8"	19.5	27.0
1/2" x 1/4"	19.5	27.0
1/2" x 3/8"	19.5	27.0
3/4" x 1/4"	21.0	27.0
3/4" x 3/8"	21.0	27.0
3/4" x 1/2"	21.0	27.0
1" x 1/4"	24.0	27.0
1" x 3/8"	24.0	27.0
1" x 1/2"	24.0	27.0
1" x 3/4"	24.0	27.0
1.25" x 3/8"	27.0	42.7
1.25" x 1/2"	27.0	42.7
1.25" x 3/4"	27.0	42.7
1.25" x 1"	27.0	42.7
1.5" x 3/8"	27.0	48.6
1.5" x 1/2"	27.0	48.6
1.5" x 3/4"	27.0	48.6
1.5" x 1"	27.0	48.6
1.5" x 1.25"	27.0	48.6
2" x 1/2"	31.0	31.0
2" x 3/4"	31.0	60.5
2" x 1"	31.0	60.5
2" x 1.25"	31.0	60.5
2" x 1.5"	31.0	60.5
2.5" x 1"	34.0	60.5
2.5" x 1.25"	34.0	60.5
2.5" x 1.5"	34.0	60.5
2.5" x 2"	34.0	60.5
3" x 1"	37.5	91.0
3" x 1.25"	37.5	91.0
3" x 1.5"	37.5	91.0
3" x 2"	37.5	91.0
3" x 2.5"	37.5	91.0
4" x 2"	44.0	116.0
4" x 2.5"	44.0	116.0
4" x 3"	44.0	116.0

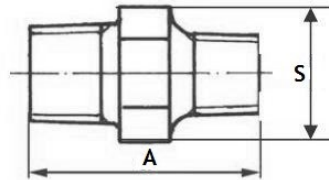

• **BSP REDUCING NIPPLE 316**

SIZE	A	S
3/8" x 1/8"	25.5	18.0
1/2" x 1/4"	30.0	21.4
1/2" x 3/8"	30.0	21.4
3/4" x 3/8"	32.0	27.0
3/4" x 1/2"	35.5	27.0
1" x 1/2"	38.5	34.0
1" x 3/4"	39.5	34.0
1.25" x 1/2"	41.5	42.7
1.25" x 3/4"	42.5	42.7
1.25" x 1"	45.0	42.7
1.5" x 3/4"	42.5	48.6
1.5" x 1"	45.0	48.6
1.5" x 1.25"	47.5	48.6
2" x 1"	49.0	60.5
2" x 1.25"	51.5	60.5
2" x 1.5"	51.5	60.5
2.5" x 2"	59.0	78.0
3" x 2"	62.5	91.0
3" x 2.5"	64.5	91.0
4" x 3"	74.0	116.0

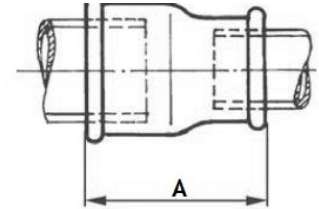

• **BSP REDUCING SOCKET 316**

SIZE	A
1/4" x 1/8"	22.8
3/8" x 1/8"	24.3
3/8" x 1/4"	27.5
1/2" x 1/8"	21.0
1/2" x 1/4"	25.0
1/2" x 3/8"	28.0
3/4" x 1/8"	22.0
3/4" x 1/4"	24.0
3/4" x 3/8"	24.0
3/4" x 1/2"	32.5
1" x 1/4"	26.5
1" x 3/8"	27.0
1" x 1/2"	29.5
1" x 3/4"	36.4
1.25" x 3/8"	29.5
1.25" x 1/2"	32.0
1.25" x 3/4"	33.0
1.25" x 1"	42.0
1.5" x 1/2"	32.0
1.5" x 3/4"	33.0
1.5" x 1"	34.5
1.5" x 1.25"	44.3
2" x 1/2"	35.5
2" x 3/4"	36.5
2" x 1"	38.0
2" x 1.25"	40.0
2" x 1.5"	47.8
2.5" x 1"	42.0
2.5" x 1.25"	44.0
2.5" x 1.5"	45.0
2.5" x 2"	47.0
3" x 1.25"	47.0
3" x 1.5"	48.0
3" x 2"	50.0
3" x 2.5"	51.0
4" x 1.5"	54.0
4" x 2"	56.0
4" x 2.5"	57.0
4" x 3"	60.0

**DIMENSIONS ARE A GUIDE
ONLY AND MAY VARY**

Tel: 01604 750380

Email: sales@bdeld.co.uk

Fax: 01604 750377

www.bdeld.co.uk