

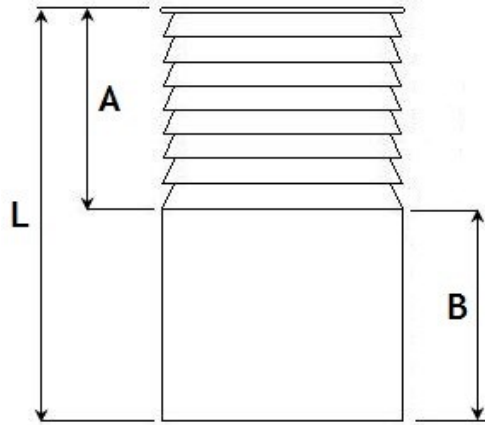

BDE (NORTHAMPTON) LTD

HOSETAILS & END CAPS



- PLAIN ENDED HOSETAILS 316**

SIZE	1/2"	3/4"	1"	1.25"	1.5"	2"	2.5"	3"	4"	5"	6"
A	25.00	25.00	50.00	50.00	50.00	50.00	50.00	50.00	50.00	85.00	85.00
B	25.00	25.00	50.00	50.00	50.00	50.00	50.00	50.00	50.00	65.00	65.00
L	50.00	50.00	100.00	100.00	100.00	100.00	100.00	100.00	100.00	150.00	150.00
THICKNESS	1.50	1.50	1.50	1.50	1.50	1.50	1.50	1.50	2.00	2.00	2.00

Made from 316 stainless steel tube

Special lengths & sizes can be produced upon request

Alternative ends can be welded - **Clamp/RJT/DIN/IDF or SMS**

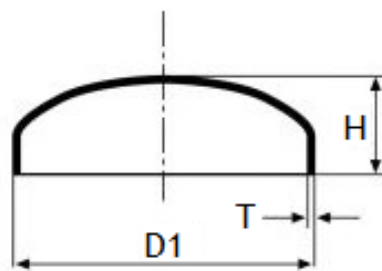

- OD END CAP 316**

SIZE	1"	1.5"	2"	2.5"	3"	4"
D1	25.00	38.00	51.00	63.50	76.10	101.60
H	12.00	15.00	19.00	19.00	27.00	24.50
T	1.60	1.60	1.60	1.60	1.60	2.00

OD End caps are a descaled finish as standard in grade 316

End caps can be polished on a short lead time

Metric caps also stocked