

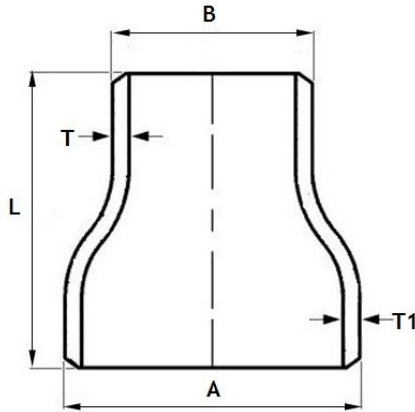

**BDE (NORTHAMPTON) LTD**

## SCHEDULE 10 & 40 - CONCENTRIC REDUCERS



### BUTT WELD CONCENTRIC REDUCER INFORMATION

- MANUFACTURED TO ASTM-A403/ANSI B16.9
- STOCKED IN 304L & 316L  
(ITEMS MARKED \*\* IN 316 ONLY)
- WELDED EX-STOCK - SEAMLESS AVAILABLE ON REQUEST

**FLANGES & FITTINGS  
AVAILABLE TO SUIT EX-STOCK**

### • NB SCH 10 - CONCENTRIC REDUCER

SIZE	A	B	L	T1	T
3/4" x 1/2"	26.6	21.3	38.0	2.11	2.11
1" x 1/2"	33.4	21.3	50.8	2.77	2.11
1" x 3/4"	33.4	26.6	50.8	2.77	2.11
1.25" x 1"	42.1	33.4	50.8	2.77	2.77
**1.5" x 1/2"	48.3	21.3	63.5	2.77	2.11
**1.5" x 3/4"	48.3	26.6	63.5	2.77	2.11
1.5" x 1"	48.3	33.4	63.5	2.77	2.77
**1.5" x 1.25"	48.3	42.1	63.5	2.77	2.77
2" x 3/4"	60.3	26.6	76.2	2.77	2.11
2" x 1"	60.3	33.4	76.2	2.77	2.77
**2" x 1.25"	60.3	42.1	76.2	2.77	2.77
2" x 1.5"	60.3	48.3	76.2	2.77	2.77
2.5" x 2"	73.0	60.3	88.9	3.05	2.77
3" x 1"	88.9	33.4	88.9	3.05	2.77
3" x 1.5"	88.9	60.3	88.9	3.05	2.77
3" x 2"	88.9	60.3	88.9	3.05	2.77
3" x 2.5"	88.9	73.0	88.9	3.05	3.05
4" x 2"	114.3	60.3	101.6	3.05	2.77
4" x 2.5"	114.3	73.0	101.6	3.05	3.05
4" x 3"	114.3	88.9	101.6	3.05	3.05
**6" x 3"	168.3	88.9	139.7	3.40	3.05
**6" x 4"	168.3	114.3	139.7	3.40	3.05
**6" x 5"	168.3	141.3	139.7	3.40	3.40

### • NB SCH 40 - CONCENTRIC REDUCER

SIZE	A	B	L	T	T1
3/4" x 1/2"	26.6	21.3	38.0	2.77	2.87
1" x 1/2"	33.4	21.3	50.8	2.77	3.38
1" x 3/4"	33.4	26.6	50.8	2.87	3.38
1.25" x 1"	42.1	33.4	50.8	3.38	3.56
**1.5" x 1/2"	48.3	21.3	63.5	2.77	3.68
**1.5" x 3/4"	48.3	26.6	63.5	2.87	3.68
1.5" x 1"	48.3	33.4	63.5	3.56	3.68
**1.5" x 1.25"	48.3	42.1	63.5	3.56	3.68
2" x 1"	60.3	33.4	76.2	3.38	3.91
**2" x 1.25"	60.3	42.1	76.2	3.56	3.91
2" x 1.5"	60.3	48.3	76.2	3.68	3.91
2.5" x 2"	73.0	60.3	88.9	3.91	5.16
3" x 1.5"	88.9	60.3	88.9	3.68	5.49
3" x 2"	88.9	60.3	88.9	3.91	5.49
3" x 2.5"	88.9	73.0	88.9	5.16	5.49
4" x 2"	114.3	60.3	101.6	3.91	6.02
4" x 2.5"	114.3	73.0	101.6	5.16	6.02
4" x 3"	114.3	88.9	101.6	5.49	6.02
**6" x 3"	168.3	88.9	139.7	5.49	7.11
**6" x 4"	168.3	114.3	139.7	6.02	7.11