

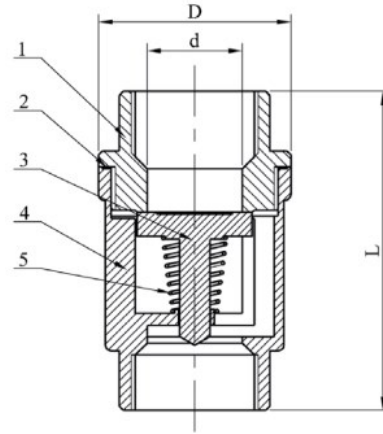

BDE (NORTHAMPTON) LTD

PN82 STAINLESS STEEL SPRING CHECK VALVE



FEATURES

- Screwed BSP Parallel
- Metal Seat
- PTFE Joint Gasket

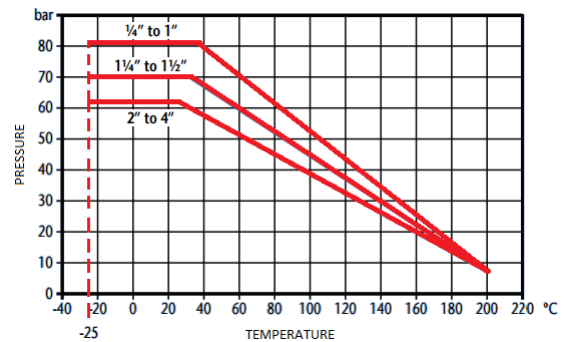

DN	1/4"	3/8"	1/2"	3/4"	1"	1.25"	1.5"	2"	2.5"	3"	4"
d	8	10	15	20	25	30	38	47	61	75	94
D	30.5	30.5	37	42	48	58	70	82	102.5	120	150
L	53	53	56	63	74	81	91	97	118	138	158
Kgs	0.18	0.17	0.21	0.29	0.40	0.65	0.98	1.40	2.44	3.80	6.60

ITEM	PART NAME	MATERIAL
1	Cap	CF8M
2	Body Gasket	PTFE
3	Disc	CF8M
4	Body	CF8M
5	Spring	316 Stainless Steel

TECHNICAL DATA

- Maximum Pressure: 1/4" - 1" = 82 Bar
1.25" - 1.5" = 69 Bar
2" - 4" = 62 Bar
- Working Temperature: -25°C to +200°C