

FERRULE ENDED 90° BEND 316L

	1"	1.5"	2"	2.5"	3"	4"
Stock Code	0901310	0901315	0901320	0901325	0901330	0901340
ØD	25.4	38.1	50.8	63.5	76.1	101.6
ØD1	50.5	50.5	64	77.5	91	119
T	1.65	1.65	1.65	1.65	1.65	2.1
L	65.5	85.5	110.5	135.5	155.5	195.5
R	37.5	57	76.5	95.3	114	153

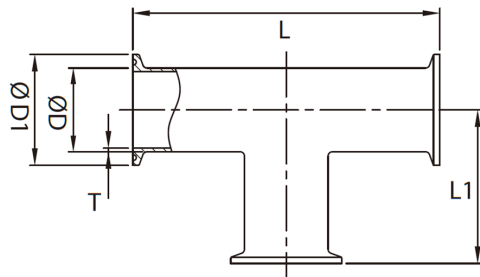

FERRULE ENDED EQUAL TEE 316L

	1"	1.5"	2"	2.5"	3"	4"
Stock Code	0940310	0940315	0940320	0940325	0940330	0940340
ØD	25.4	38.1	50.8	63.5	76.1	101.6
ØD1	50.5	50.5	64	77.5	91	119
T	1.65	1.65	1.65	1.65	1.65	2.1
L	131	171	221	271	311	391
L1	65.5	85.5	110.5	135.5	155.5	195.5

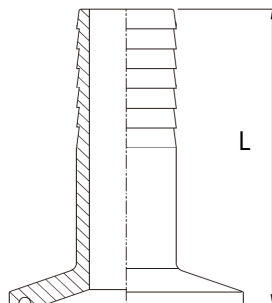

FERRULE ENDED HOSETAIL 316L

	1/2"	3/4"	1"	1.5"	2"	2.5"	3"	4"	5"	6"
Stock Code	0304105	0304107	0304110	0304115	0304120	0304125	0304130	0304140	0304150	0304160
L	71.5	71.5	121.5	121.5	121.5	121.5	121.5	121.5	178	178